

**Comp-DS** Driveshaft

---

*User Manual 2010-1378A*

**➤ Marley**

---

## Driveshaft-Parts List

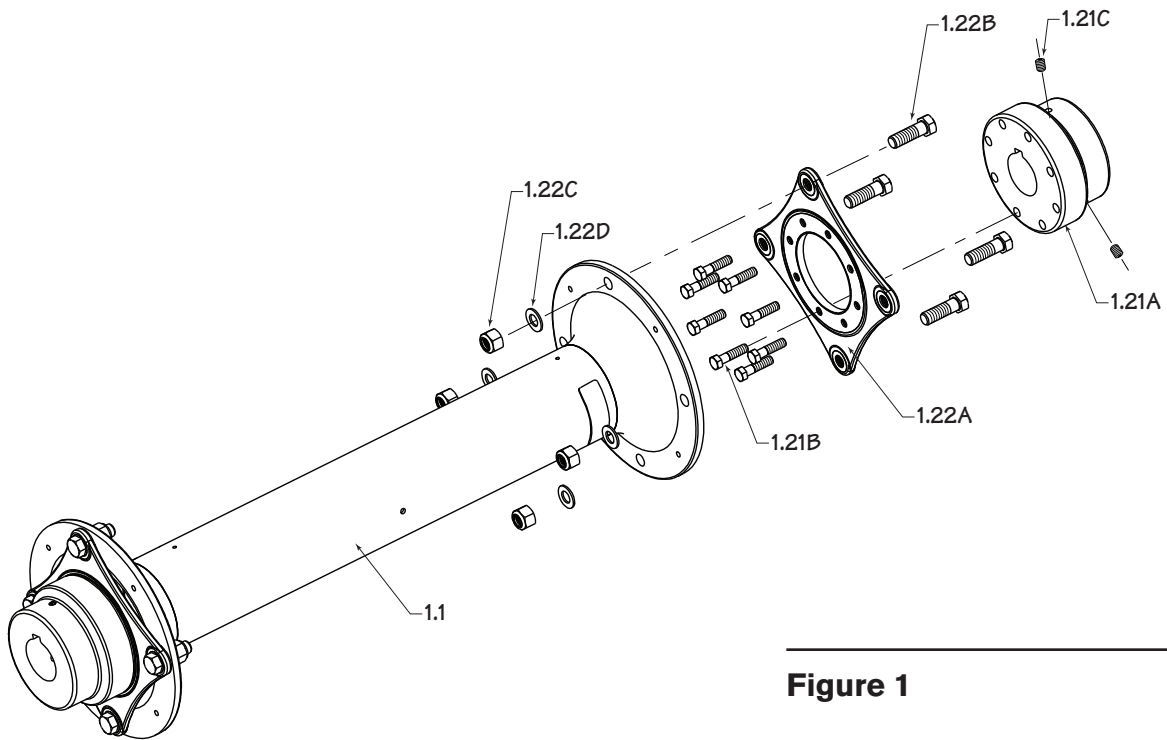

---

**Figure 1**

- 1.0 Complete Driveshaft
- 1.1 Tube and Flange Assembly
- 1.2 Coupling Assembly (2 required per driveshaft) complete with hub, flexible-element, cap screws, washers, lock nuts and set screws.
- 1.21 Hub Assembly
  - A. Hub
  - B. Cap Screws (8 required per hub)
  - C. Set Screws (2 required per hub)
- 1.22 Flexible-Element Assembly
  - A. Flexible Element
  - B. Cap Screws (4 required per flexible-element)
  - C. Lock Nuts (4 required per flexible element)
  - D. Washers (4 required per flexible element)

---

### Note

***When ordering parts, always provide the cooling tower serial number and when possible, the driveshaft serial number from a decal located on the composite tube.***

---

## ***Safety and Handling Considerations***

### **Safety Warning**

---

**⚠ Warning**

***Because of the potential for property damage and/or danger to person(s), it is critical to follow the proper selection, installation and operating procedures.***

***Exposed rotating devices are potentially dangerous and can cause injury or death. They must be guarded in compliance with OSHA, ANSI and all other local standards for the specific application.***

***All personnel must follow applicable work safety standards, such as Lockout/Tagout procedures while working in or around power transmission devices.***

### **Handling Considerations**

1. Marley Comp-DS Series driveshafts are designed and manufactured to be very durable. They will provide years of service if handled properly.
2. Minor aesthetic imperfections, such as surface abrasions, scuffs or small bumps may be present from manufacturing or handling and will not affect performance. Heavy, concentrated impacts may cause gouges, penetration or soft spots in the composite components. If any damage is observed, the driveshaft should not be placed into service. Only SPX Engineering is authorized to approve any issues exceeding the above description of minor aesthetic imperfections.
3. The entire driveshaft should be inspected periodically or after a strenuous event such as excessive torque or misalignment. Particularly the flexible-element. Refer to the maintenance section for further information.
4. Unless replacing the flexible-element, for maintenance purposes, never remove the cap screws that connect the flex-element to its adjacent hub. Factory thread locker will be compromised and the warranty will be voided.

---

# Installation

## General

Marley Series Comp-DS driveshafts consist of a tube and flange assembly with motor and Geareducer® couplings. Comp-DS driveshafts are dynamically balanced at the factory as a complete assembly. Flanges and hubs are match-marked and balanced. Do not change position or relation of match-marked components during installation. If tube and flange assemblies are replaced or either hub bore size is changed, the driveshaft must be rebalanced. It may be performed on the tower by an experienced service contractor or returned to an authorized manufacturing facility.

---

### ⚠ Warning

**All fasteners that connect to the flexible-element must NOT be over-tightened. If over-tightened, they will become loose over time and serious property damage and/or injury to person(s) may result. Refer to Table 2 for torque values.**

## Installation

Before installing the driveshaft, be sure the motor and Geareducer are on level bases and their shafts are in reasonable alignment.

1. Note match-mark numbers on the driveshaft flanges and hubs; then remove the coupling assemblies from either end by removing only the flexible-element fasteners (1.22B, 1.22C and 1.22D).

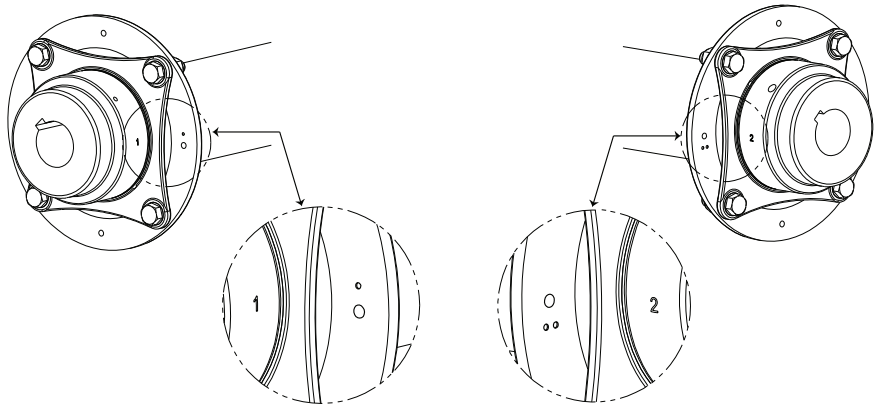

---

**Figure 2**

---

### ⚠ Caution

**The hub assembly cap screws (8 per hub) that connect the flexible element to the hub are factory assembled with thread lock compound. They should NOT be loosened or removed when installing the driveshaft. These hub fasteners are to be removed only when replacing the flexible-element for maintenance purposes and must be reinstalled with OEM supplied thread lock compound that is included in the replacement flex-element kit.**

2. Remove any burrs or scratches from the motor or Geareducer shafts and coat both shafts with an anti-seize compound.
3. Insert both keys into their corresponding keyways. Ensure they are fully seated.

---

## Installation

---

### Note

**Some driveshafts utilizing large bore hubs may come supplied with a rectangular key. If applicable, the supplied key must be used.**

4. Start the driveshaft installation by sliding the couplings (hubs with attached flex-elements) onto their respective shafts. Slide them onto the shaft ends with approximately one inch of shaft protrusion through the flex-element opening as shown in the Figure 3.

---

### Note

**There are some large motor shafts that will not clear the motor end flex-element aperture. If this is the case, slide that end on as far as possible and add another inch of protrusion to the Geareducer end input shaft exposure.**

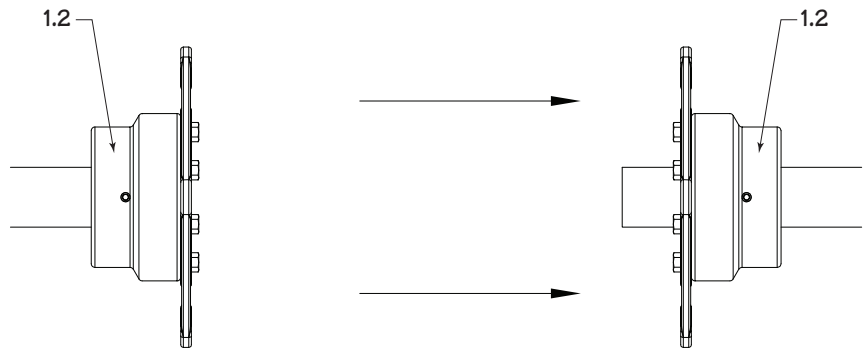

---

**Figure 3**

5. Lift driveshaft tube and flange assembly into place as shown in Figure 4 and support approximately level. Ensure flanges are oriented near the correct hubs (refer to match-marks).

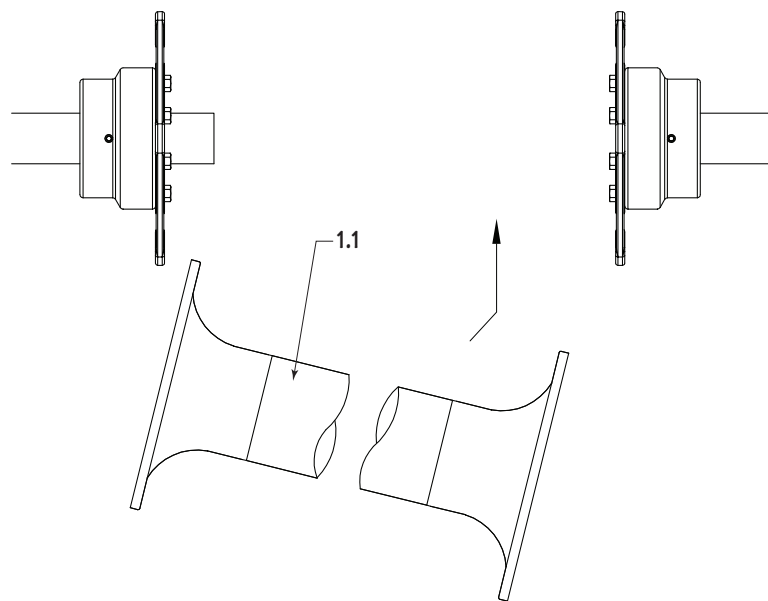

---

**Figure 4**



---

## Installation

- Adjust hub engagement on Geareducer input shaft so that the hub hangs off of the shaft approximately  $\frac{1}{8}$ " and align match-mark to adjacent flange match-mark.

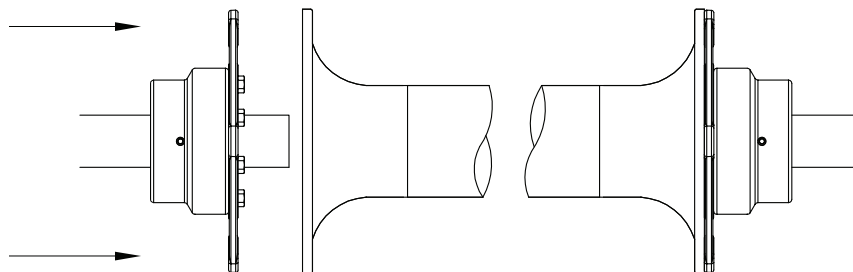

---

**Figure 5**

- Insert the four cap screws through the Geareducer end coupling assembly and flange. Ensure the cap screw head is towards the outside of the driveshaft assembly (i.e. hub side of driveshaft), as shown in Figure 6. Install the four washers and lock nuts and progressively tighten to the value specified in Table 2. Do not lubricate these fasteners.

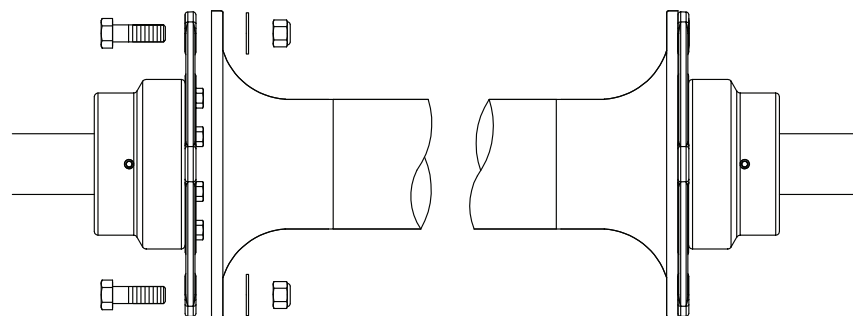

---

**Figure 6**

- Repeat steps 6 and 7 for motor end coupling assembly.

---

**⚠ Caution**

***It may be necessary to adjust the method of support initiated in Step 6. Do NOT allow the entire weight of the driveshaft to be cantilever supported by either coupling at anytime. Flex-element damage may result and the warranty will be voided.***

---

**Note**

***If installing motor end flex-element hardware is challenging, large-scale misalignment may exist. Symptoms of this scenario may consist of some or none of the flex-element cap screws easily sliding through the adjacent flange fastener holes. If this situation exists, the motor and Geareducer positioning should be adjusted as necessary.***

## Installation

- Inspect engagement on both hubs (see Table 1) and ensure that engagement is within tolerance. It may be necessary to adjust the position of the entire driveshaft assembly. Furthermore, it may be required to slightly modify the location of the motor to affect the distance between shaft ends.

Table 1

Hub Engagement		
Series	Inches	Millimeters
Comp-4	$2\frac{7}{8} + \frac{1}{8} - \frac{3}{8}$	73 +3.1 -9.5
Comp-6	$3\frac{5}{8} + \frac{1}{8} - \frac{3}{8}$	92.1 + 3.1 -9.5

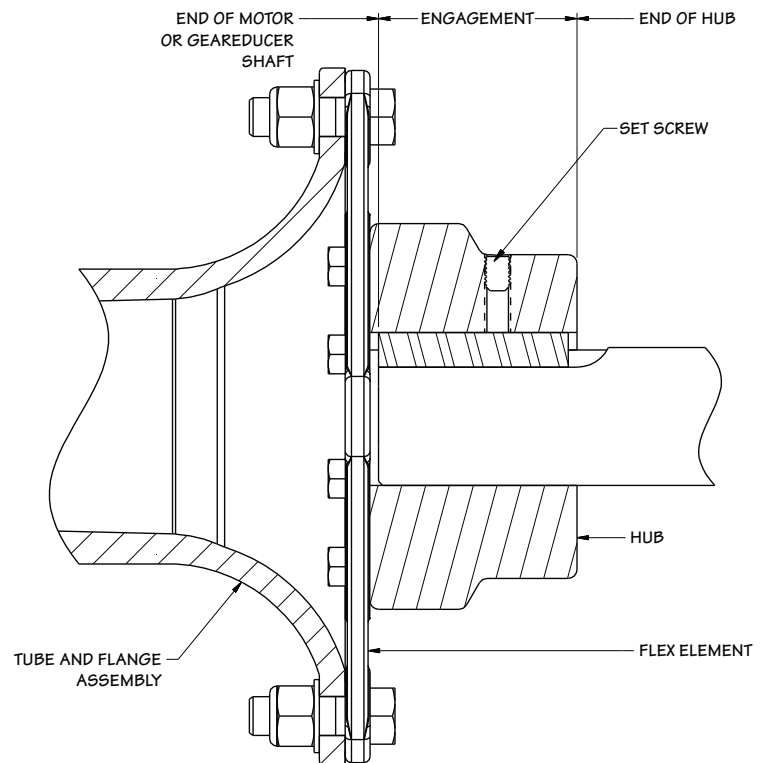

Figure 7

- With set-screws backed out, rotate the driveshaft (by hand) a couple of rotations.
- Tighten all set-screws. Proceed with alignment procedure.

---

# Alignment

## General

Marley Series Comp-DS driveshafts are designed to accommodate up to a certain amount of misalignment. They must be installed within axial **and** angular tolerance to ensure long life and retain the warranty. These two forms of alignment are independent of one another and correcting one may interfere with the other. Alignment must be checked at each coupling.

Move motor and/or Geareducer vertically by shimming, or horizontally by shifting on support.

Eliminate any large-scale misalignment before proceeding. Then check for axial alignment to ensure the driveshaft overall length (OAL) isn't adversely affected by the hub and/or equipment placement.

**Soft Foot:** The motor and Geareducer must seat firm and flat against their respective supports during all alignment inspection(s). If equipment location is adjusted, the support feet must be secured before rechecking alignment.

## Axial Alignment

Special care must be given to the axial hub positioning. If the OAL is effectively too long or short, it will shorten the flex-element service life. The best method for avoiding this, is to always ensure the set screw torque is relieved when adjusting the motor or Geareducer. In other words, never move the Geareducer or motor axially (closer together or farther apart) after the driveshaft set screws are tightened.

## Angular Alignment

Use a firm and secure means of attaching a dial indicator base to the hub and align the indicator point to contact the center of a flex-element cap screw head (connection point between flex-element and flange). If using a Marley "Driveshaft Alignment Indicator Kit", fasten the base of the kit into the tapped hole, located 90° from the keyway, with the supplied thumbscrew (refer to Fig. 8). Rotate the driveshaft, by hand, to ensure the dial indicator remains in contact with the cap screw and that its travel doesn't "bottom out."

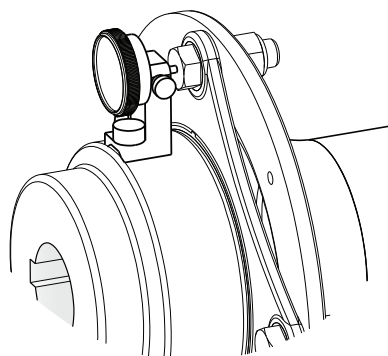

Marley Driveshaft Alignment Indicator

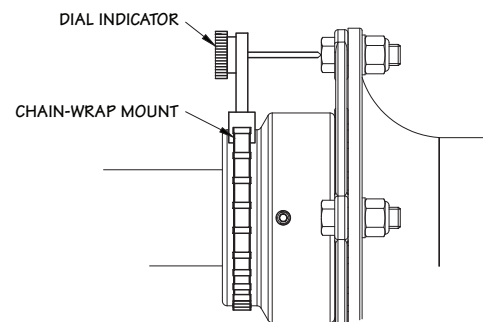

Alternative Alignment Method – Typical Chain-Wrap Mount

---

Figure 8

---

## ***Alignment***

Check alignment at each end of the driveshaft by rotating the shaft through 360° noting the total change in the dial indicator reading. The total indicator reading should not exceed 0.012" (0.3 mm).

---

### **Note**

***Total indicator reading is the absolute value sum (e.g. +5 and -7 mils readout through one revolution equals 12 mils TIR).***

### **Final**

Ensure all fasteners are tight (see Table 2) before placing aligned driveshaft into service.

- Set Screws
- Cap Screws
- Geareducer Jacking Bolts on Rear Feet (drill holes and use dowel pins, if necessary)
- Geareducer and Motor Support Bolts

---

<b>All Comp-DS Series</b>			
<b>Fastener</b>	<b>Torque Values</b>		
	Inch Pounds	Foot Pounds	Newton Meters
Setscrew: $\frac{3}{16}$ -16	240	20	27
Cap Screw: $\frac{3}{8}$ -16	360	30	40
Cap Screw: $\frac{9}{16}$ -12	600	50	68

---

**Table 2**

---

# Maintenance

## General

Inspection of the complete driveshaft should be made every six months. Marley Series Comp-DS driveshafts do not require lubrication. If hubs and/or tube and flange assemblies are replaced, the driveshaft must be rebalanced. It may be performed on the tower by an experienced service contractor or returned to an authorized manufacturing facility.

## Hardware

Look for corrosion, loose cap screws and set screws. Also check driveshaft alignment. If as-installed alignment has changed, motor and Geareducer support hardware should be checked for looseness.

## Composite

The tube and flange assembly should be inspected for excessive fiber bloom and cracks. The flex-element assembly should be inspected for cracks or excessive crazing in the urethane as well as any exposed areas of the carbon-fiber reinforcement.

## Replacing Flexible-Elements

It is recommended to replace the flex-elements at least every five years on a preventative maintenance schedule. To do this:

1. Loosen the set screws.
2. Remove the tube and flange assembly.
3. Remove the coupling assemblies.
4. Secure the hub in a vice or something similar and remove the eight hub cap screws.

---

## Note

***It may be necessary to use localized heat to aid thread locker breakdown and cap screw removal. Additionally, it may be necessary to clean out the tapped hole threads.***

5. Remove and replace the flex-element. Be sure to align a flex-element tab/ear to the hub keyway (see Figures 1 and 2).
6. Re-install the cap screws using the supplied thread locker and torque to the specified value. See Table 2.
7. Refer to the Installation section within this manual to reinstall and align driveshaft assembly.



**SPX**<sup>®</sup>

SPX COOLING TECHNOLOGIES, INC  
7401 WEST 129 STREET  
OVERLAND PARK, KANSAS 66213  
UNITED STATES  
913 664 7400 | [spxcooling@spx.com](mailto:spxcooling@spx.com)  
**[spxcooling.com](http://spxcooling.com)**

In the interest of technological progress,  
all products are subject to design and/or  
material change without notice.

©2011 SPX | Printed in USA

**M2010-1378A**