

*/ Marley HC Valve 4" thru 8" Diameter /*

---

*User Manual 92-1371*



## Marley / HC Valve 8" Diameter /

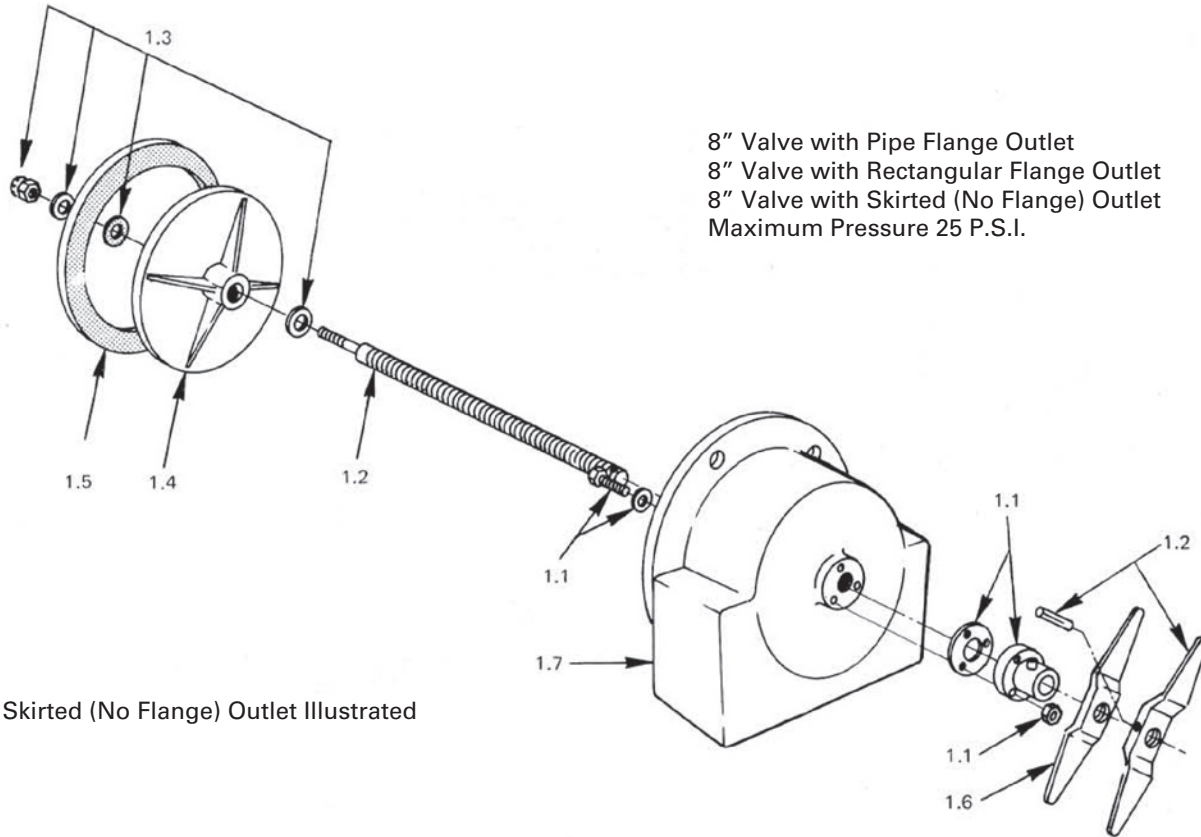

### / Replacement Parts /

- 1.0 Complete Valve Assembly  
Ready for installation.
- 1.1 Valve Stem Guide With Grease Fitting, Gasket  
and Attaching Hardware
- 1.2 Operating Handle, Valve Stem, Pin
- 1.3 Washers, Resilient Washer, Self-Locking Nut
- 1.4 Valve Disc
- 1.5 Valve Body Gasket
- 1.6 Locking Bar
- 1.7 Valve Body

### / Assembly Sequence /

1. Attach valve stem guide and gasket to valve body.
2. Place valve disc and washers on valve stem. Install self-locking nut and tighten to compress resilient washer to  $\frac{1}{8}$ " to  $\frac{3}{16}$ " thick.
3. Install valve stem and disc sub-assembly through valve stem guide. Center valve disc in valve inlet opening by differential tightening of the three valve stem guide machine bolts.
4. Install locking bar on valve stem.
5. Install operating handle on valve stem and insert pin through valve stem and operating handle.
6. Grease valve stem threads at grease fitting using rust inhibiting lithium base grease of NLGI No. 2 consistence. Coat exposed valve stem threads with grease.
7. After adjusting the flow, set the locking bar in the locked position to stabilize the stem and disc.

When ordering parts always provide original Marley tower order number and tower serial number. Contact the Marley sales representative in your area for assistance.

**SPX** **Cooling Technologies**

Balcke | Hamon Dry Cooling | Marley

---

/ 7401 W 129 Street // Overland Park, KS USA 66213 // +1 913 664 7400 // [spxcooling@ct.spx.com](mailto:spxcooling@ct.spx.com) // [spxcooling.com](http://spxcooling.com) /

In the interest of technological progress, all products are subject to design and/or material change without notice.  
©2007 SPX Cooling Technologies, Inc. | Printed in USA

Manual 92-1371