

HP7i Fan Parts Manual

72" through 168" Diameter—6 Blade

PL-HP7-97-168

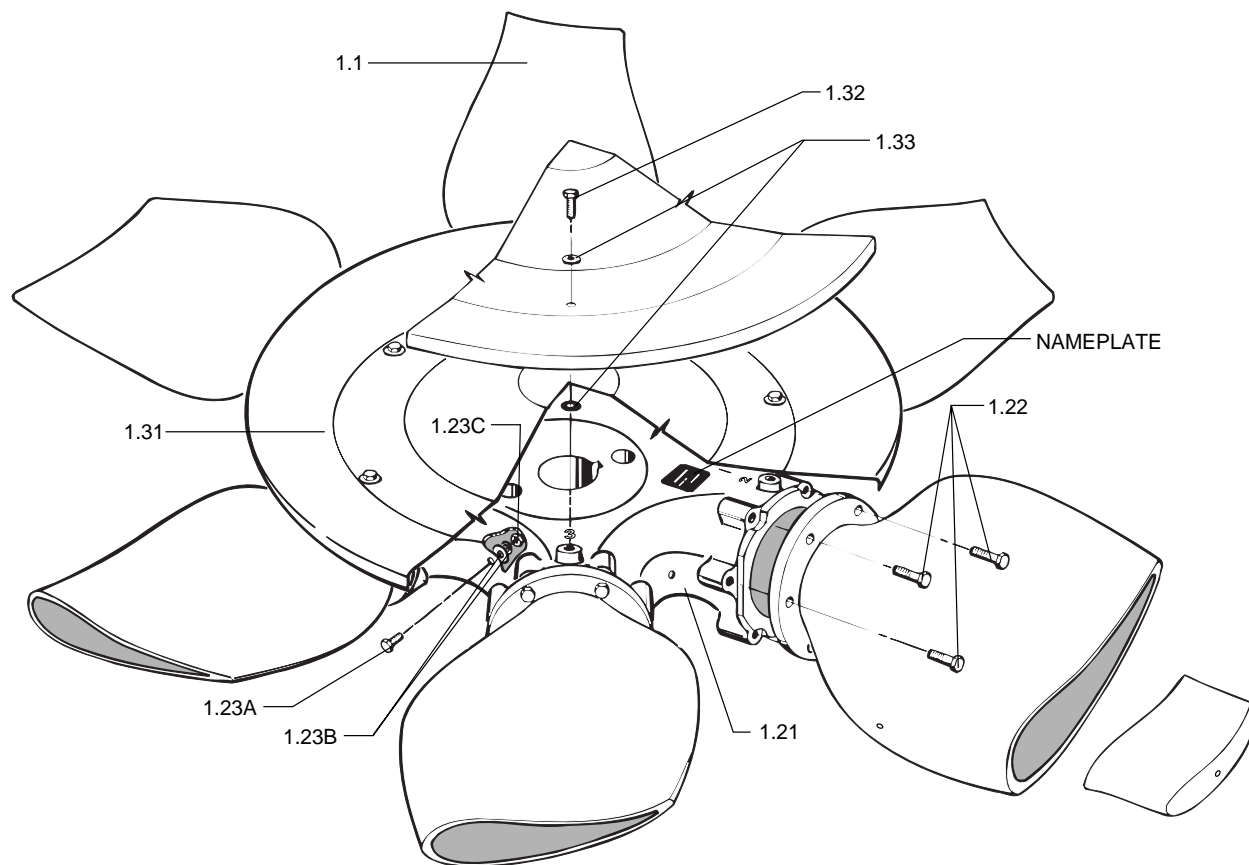

Replacement Parts

1.0 COMPLETE FAN ASSEMBLY

Factory Balanced

1.1 FAN BLADE AND RETAINING RING

1.2 FAN HUB ASSEMBLY

- 1.21 Fan Hub
- 1.22 Cap Screws
- 1.23 Balance Weights
 - 1.23A Machine Bolt
 - 1.23B Washers
 - 1.23C Nut

1.3 HUB COVER AND ATTACHING HARDWARE

- 1.31 Hub Cover
- 1.32 Cap Screws
- 1.33 Resilient Washers

Ordering Parts

Refer to Fan Service Manual before ordering parts. Your order should include the following information:

- Fan type, diameter and number of blades.
- Item number, description and quantity.
- Original Marley Tower Order number or Tower Serial Number.

Contact your Marley Sales Office or Representative for assistance on order placement.



Marley Cooling Tower

A United Dominion Company

The Marley Cooling Tower Company
7401 W 129 Street • Overland Park, KS 66213 • 913.664.7400

In the interest of technological progress, all products are subject to design and/or material change without notice.

©1997 Marley Cooling Tower

Printed in USA

Manual 92-1396B