

HP7i Fan Parts Manual

169" through 216" Diameter—6 Blade

PL-HP7-169-216A

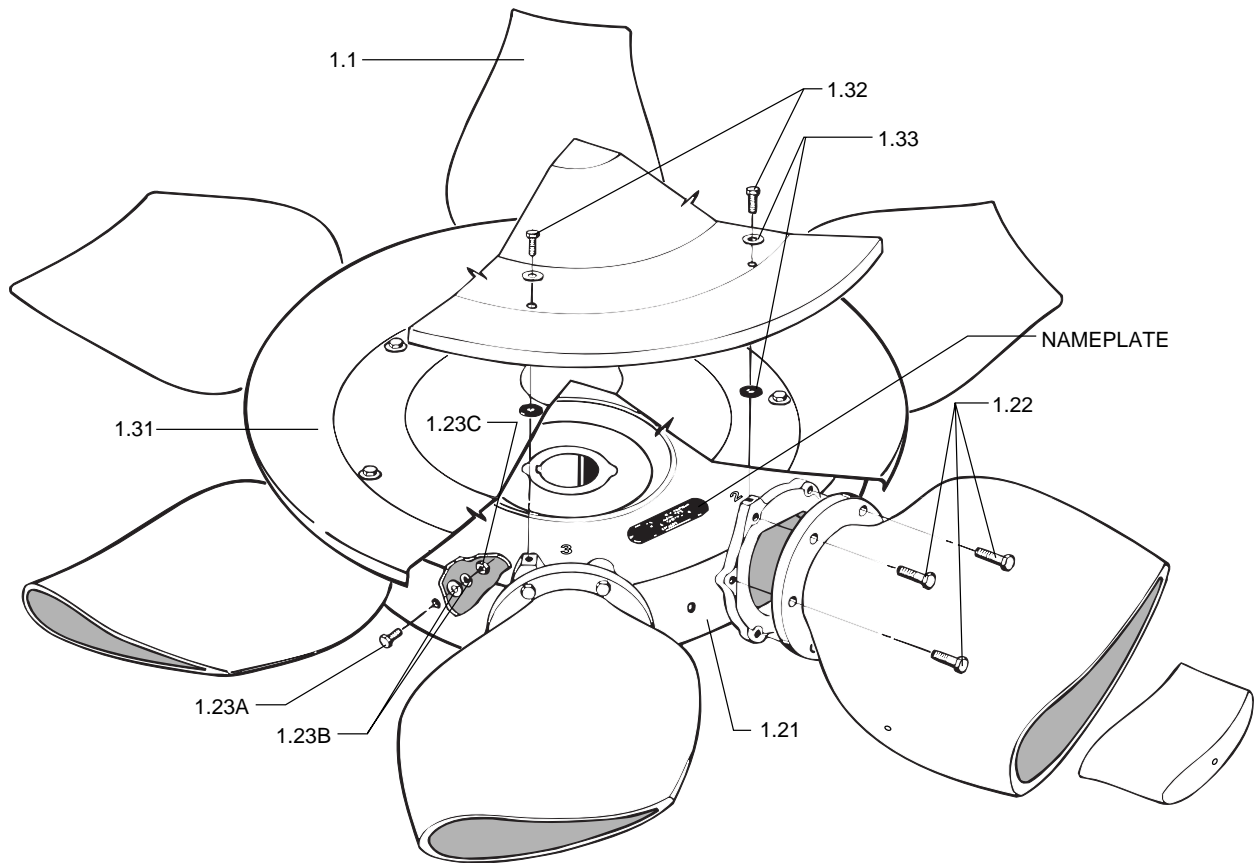

Ordering Parts

Refer to Fan Service Manual before ordering parts. Your order should include the following information:

- Fan type, diameter and number of blades.
- Item number, description and quantity.
- Original Marley Tower Order number or Tower Serial Number.

Contact your Marley Sales Office or Representative for assistance on order placement.

Replacement Parts

1.0 COMPLETE FAN ASSEMBLY

Factory Balanced

1.1 FAN BLADE AND RETAINING RING

1.2 FAN HUB ASSEMBLY

- 1.21 Fan Hub
- 1.22 Cap Screws
- 1.23 Balance Weights
 - 1.23A Machine Bolt
 - 1.23B Washers
 - 1.23C Nut

1.3 HUB COVER AND ATTACHING HARDWARE

- 1.31 Hub Cover
- 1.32 Cap Screws
- 1.33 Resilient Washers



Marley Cooling Tower

A United Dominion Company

The Marley Cooling Tower Company
7401 W 129 Street • Overland Park, KS 66213 • 913.664.7400

In the interest of technological progress, all products are subject to design and/or material change without notice.

©1999 Marley Cooling Tower

Printed in USA

Manual 92-1395A