

# IEC Spare Parts Selection

827 W Progress Dr. | Dixon, IL 61021 | 815 284 2700 | partsales@spx.com

- 1. Drift Eliminators
- 2. Spray Branches
- 3. Spray Nozzles
- 4. Coil
- 5. Mastic/Field Seam
- 6. Door
- 7. Handle Non-Lock
- 8. Handle Padlocking**
- 9. Pump
- 10. Suction Screen**
- 11. Fan Guard

Additional parts not shown:

- Control Panel
- Vibration Switch

**Items in BOLD are not shown on the image and are provided for locational reference.**

For platform, ladder or gate replacement, see **IEC Platform Selection Guide**

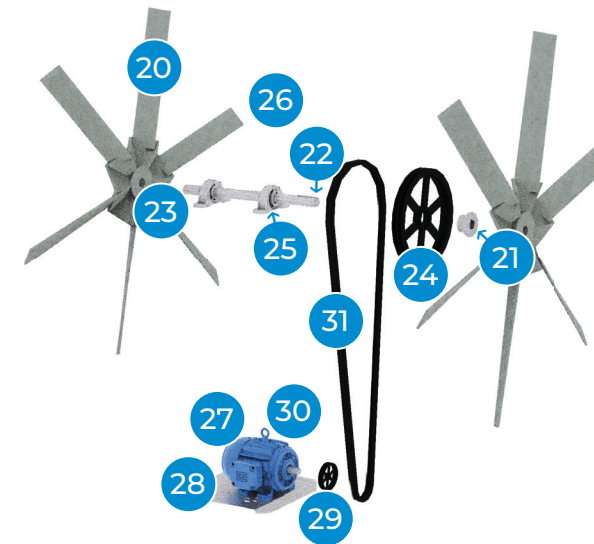
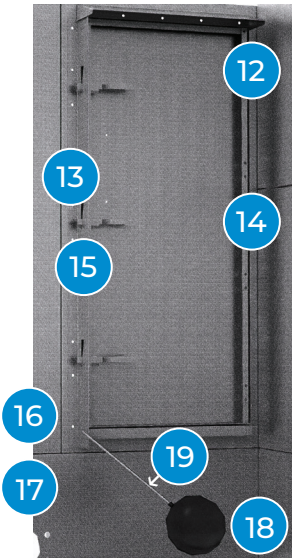
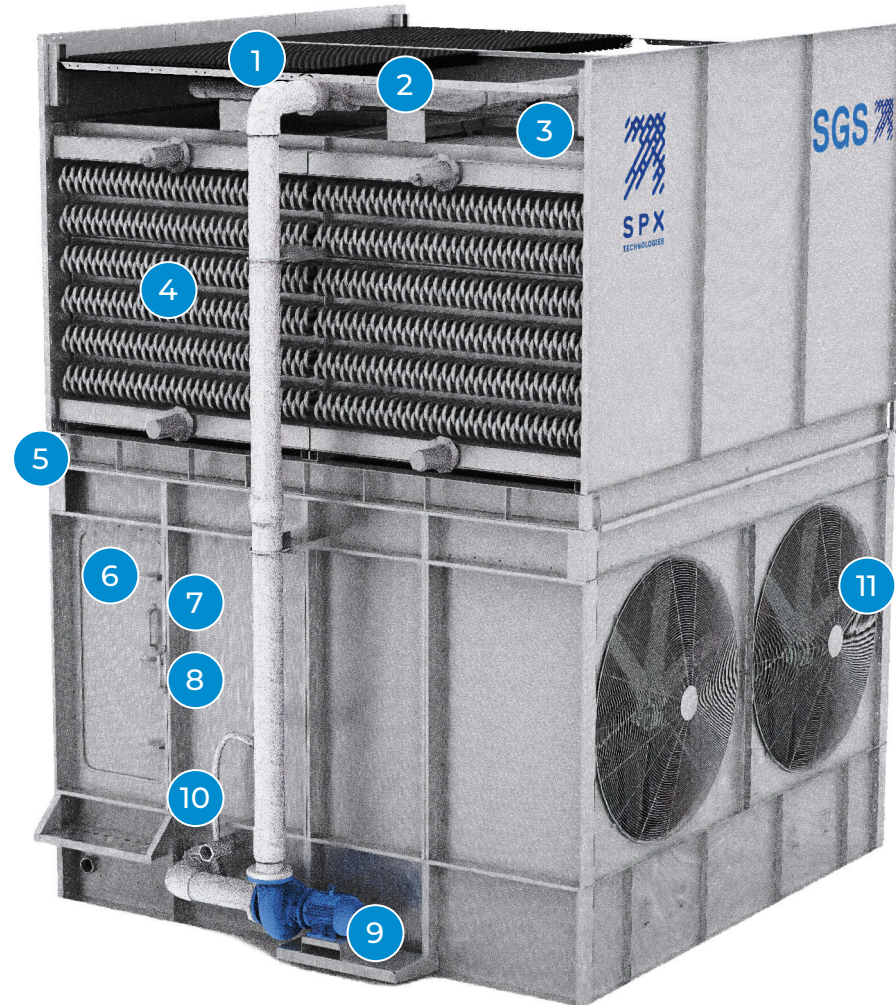

- 12. Door Gasket Trim
- 13. Door Latch
- 14. Door Hinge
- 15. Door Flat Cam
- 16. Float Switch**
- 17. Float Valve**
- 18. Float 8" Plastic
- 19. Float Stem
- 20. Fan (Prop)
- 21. Fan Bushing
- 22. Fan Shaft
- 23. Fan Key**
- 24. Fan Sheave
- 25. Bearing Pillow Block
- 26. Grease Line**
- 27. Fan Motor
- 28. Motor Support
- 29. Motor Sheave
- 30. Motor Bushing**
- 31. Belt
- 32. Electric Basin Heater Package

## Customer Information

Name: \_\_\_\_\_  
 Company: \_\_\_\_\_  
 Email: \_\_\_\_\_  
 Phone: \_\_\_\_\_  
 IEC Model: \_\_\_\_\_  
 Order # (if known): \_\_\_\_\_

## SGS Sales Contact

Name: \_\_\_\_\_  
 Phone: \_\_\_\_\_  
 Email: \_\_\_\_\_