

MARLEY®

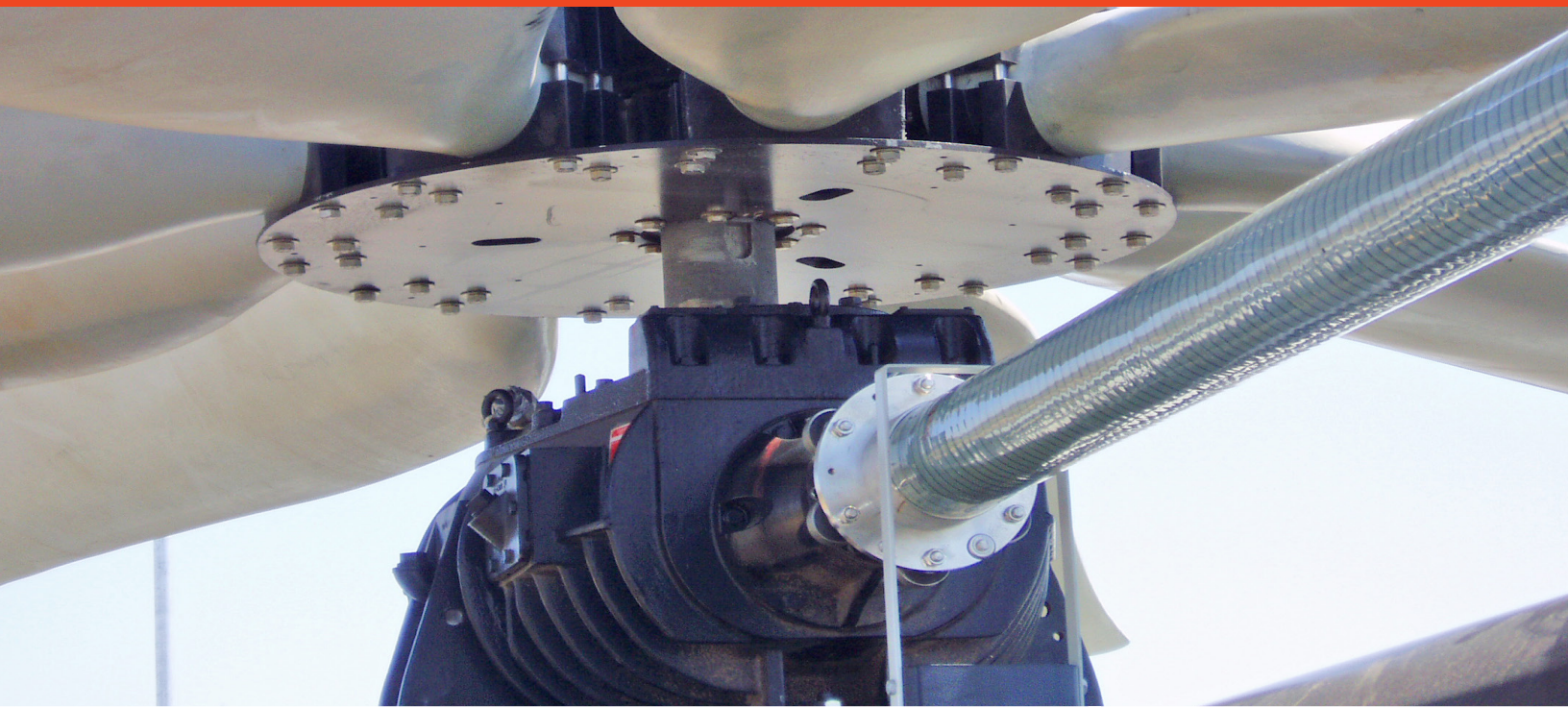

cooling tower upgrades using
Marley Geareducer® systems



Give your cooling tower a new lease on life with a genuine Marley Geareducer!

Extend the operational lifespan of your evaporative cooling system, regardless of manufacturer, by equipping it with genuine Marley mechanical components. Replace your aging gearbox* with a Marley Geareducer and lock in a 2-year warranty and lower maintenance costs.

*Gearbox Brand
Amarillo
David Brown
Ecodyne
Falk
Flender
Fluor-Western
Hansen
Hub City
Lufkin
Nuttall
Philadelphia Gear
SEW
Sumitomo
Textron

① Marley Geareducer

- 3X more bearing life than single row bearings**
 - *Double row interstage shaft bearings*
- External fins help promote cooler operation
 - *47% more surface area; larger oil passageways*
- Standard models in stock
- Up to 80% lower overall sound**
- Stronger single-piece pinion-to-gear connection
- No external vent line required
- Options
 - *Low level oil indicator switch*
 - *Anti-reversing devices*

② Marley COMP-DS Driveshaft

- Combination of materials including carbon fiber, stainless steel and UV inhibitors provide strength, flexibility and durability

③ Support Plate

- 1" HDG steel plate platform with jacking screws standard, other materials available
- Engineered to fit your specific cooling tower

④ Fan Hub Bushing

- Adapts output shaft to existing fan
- Not required for Marley fan

**Consult your Marley technical expert for test data and verification details.

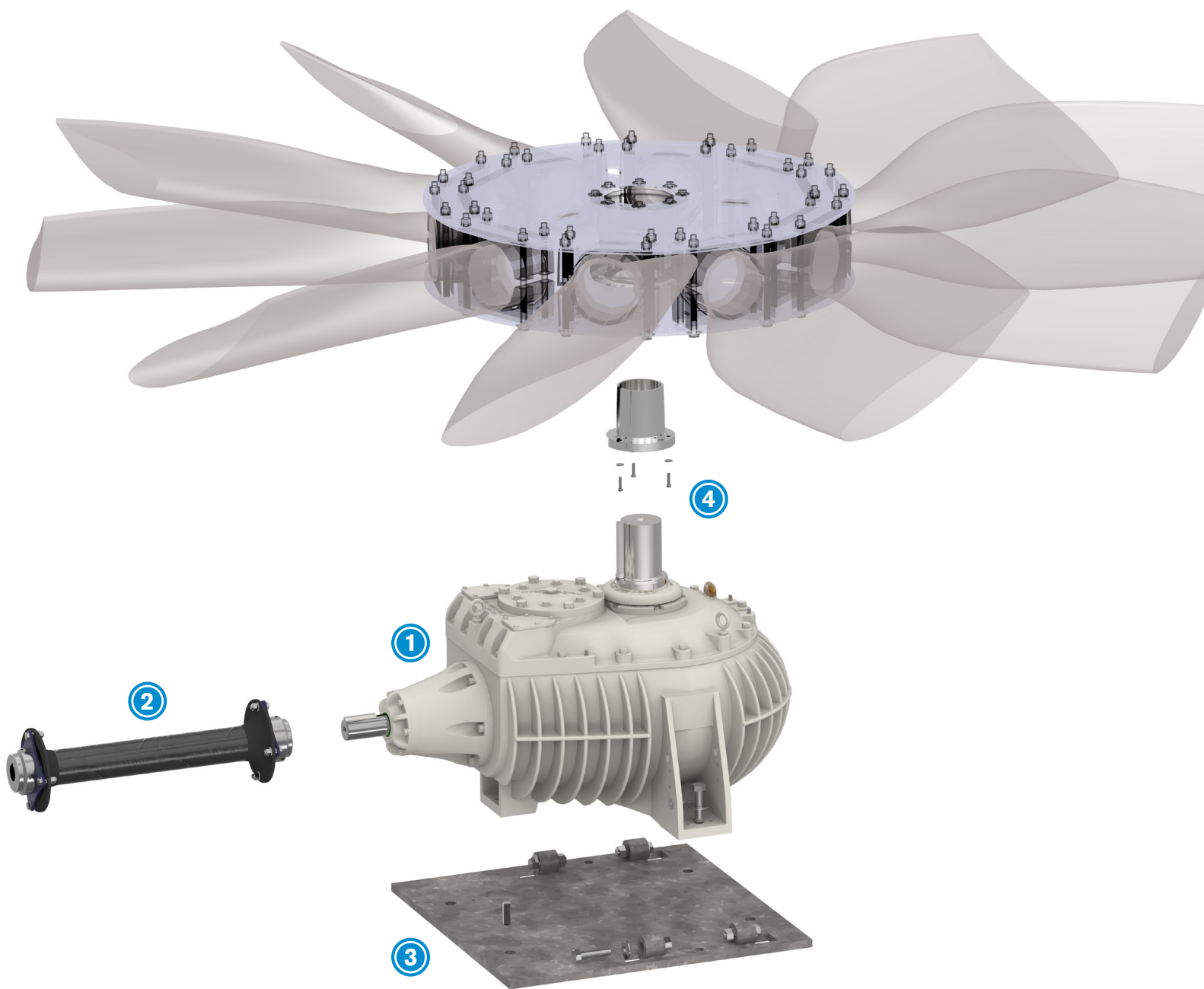

Genuine Marley mechanical system components will help your cooling tower, regardless of original manufacturer, operate efficiently for many years.

Find your Marley technical expert at spxcooling.com/relocator, 1-800-4Marley or spxcooling@spx.com



SPX COOLING TECHNOLOGIES, INC.

7401 WEST 129 STREET
OVERLAND PARK, KS 66213 USA
913 664 7400 | spxcooling@spx.com
spxcooling.com

UP-GRDR-18 | ISSUED 04/2018

COPYRIGHT © 2018 SPX Cooling Technologies, Inc. All rights reserved.
In the interest of technological progress, all products are subject to design
and/or material change without notice.

