

32.2 Series Geareducer®

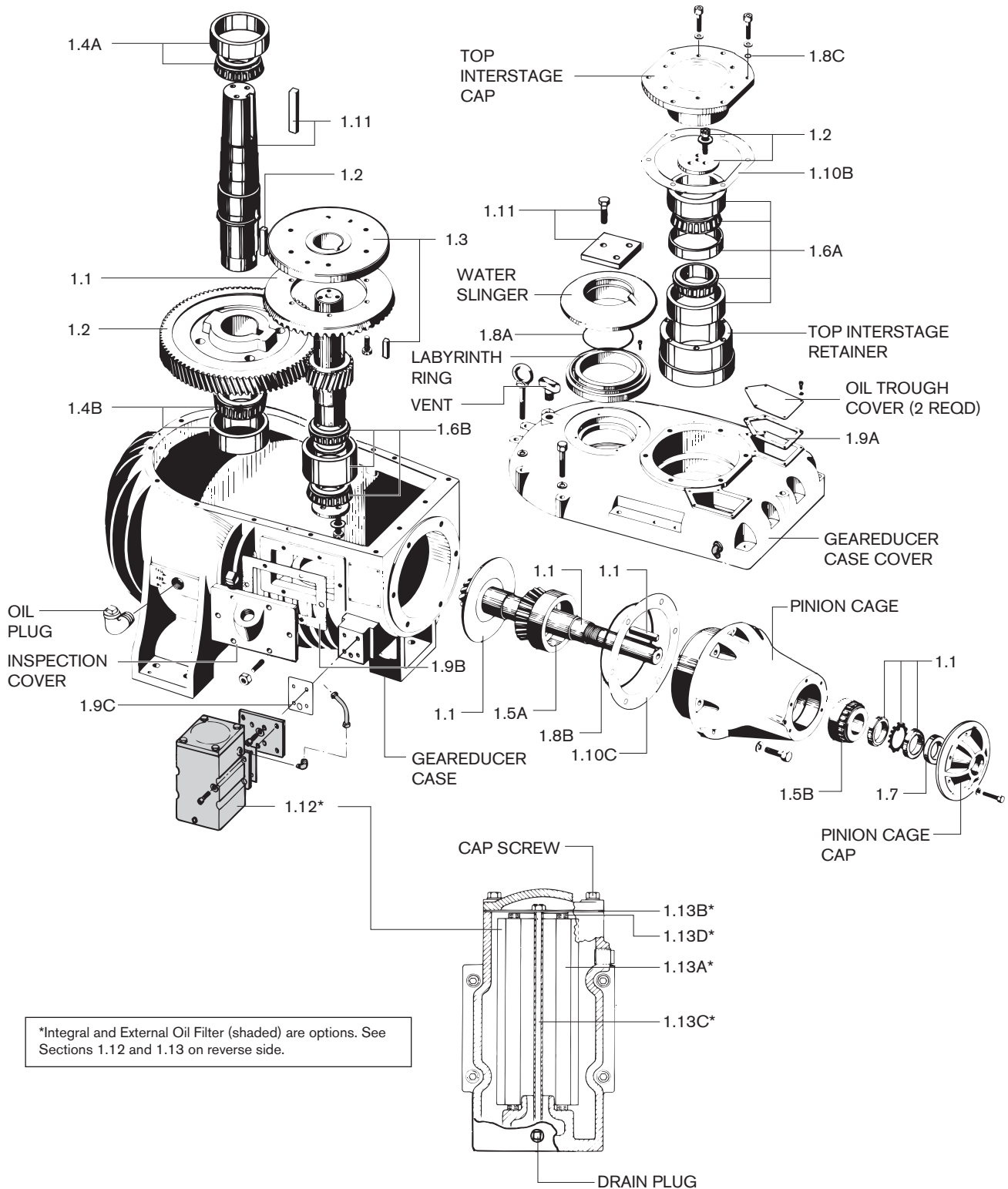

*Integral and External Oil Filter (shaded) are options. See Sections 1.12 and 1.13 on reverse side.

1.0 COMPLETE GEAREDUCER ASSEMBLY

Ready for installation.

1.1 SPIRAL BEVEL GEAR SET

With pinion shaft, oil slinger, lock nuts, washer, key and place bolts.

- Overall gear ratio of 12.93 :1, 11.18:1, 9.62:1 8.80:1, or 7.89:1 must be noted when ordering replacement parts.

Note: Oil slinger is not included in gear set.

1.2 HELICAL GEAR SET

With interstage shaft, discs, place bolts, retaining ring and key.

- Key is high strength alloy steel and must be obtained from Marley.
- Overall gear ratio of 12.93 :1, 11.18:1, 9.62:1 8.80:1, or 7.89:1 must be noted when ordering replacement parts.

1.3 SPIRAL BEVEL GEAR HUB AND KEY

- Key is high strength alloy steel and must be obtained from Marley.

1.4 SET OF TWO FAN SHAFT BEARINGS

- A.** Upper tapered roller bearing.
- B.** Lower tapered roller bearing.
- Must be obtained from Marley.

1.5 SET OF TWO PINION SHAFT BEARINGS

- A.** Head tapered roller bearing.
- B.** Tail tapered roller bearing.

1.6 SET OF TWO INTERSTAGE SHAFT BEARINGS

- A.** Upper tapered roller bearing.
 - Must be obtained from Marley.
- B.** Lower tapered roller bearing.

1.7 PINION SHAFT OIL SEAL

2-3/8 ID x 3-1/2 OD x 7/16 or 1/2.

1.8 SYNTHETIC RUBBER O-RING SEALS

- A.** Water slinger seal, 4-1/2 ID x 4-7/8 OD x 3/16.
- B.** Pinion cage seal, 9-3/4 ID x 10 OD x 1/8.
- C.** Top Interstage cage cap seal, 1/2 ID x 5/8 OD x 1/16 (6 required).

1.9 GASKET SET

- A.** Oil trough gasket (2 required).
- B.** Inspection opening gasket.
- C.** Oil pickup opening gasket.

1.10 SHIM KIT

- A.** Fan shaft shims (not shown).
- B.** Interstage shaft shims.
- C.** Pinion cage shims.

1.11 FAN SHAFT ASSEMBLY

Complete with retention plate and key.

- Key is high strength alloy steel and must be obtained from Marley.

1.12 INTEGRAL OIL FILTER ASSEMBLY

Complete with gasket and mounting bolts.

1.13 INTEGRAL OR EXTERNAL FILTER CARTRIDGE ASSEMBLY

- A.** Replacement cartridge. Briggs Filtration Part No. BP-509-W or equal.
- B.** Cap gasket.
- C.** Center pipe and nut.
- D.** Washer, cartridge retainer.

When ordering parts, always include tower serial number, Geareducer serial number and Geareducer Series if available. Contact the Marley sales representative in your area for assistance.

SPX COOLING TECHNOLOGIES, INC.

7401 WEST 129 STREET
OVERLAND PARK, KS 66213 USA
913 664 7400 | spxcooling@spx.com
spxcooling.com

Z0238912_A (92-1354B) | ISSUED 06/2017

COPYRIGHT © 2017 SPX CORPORATION

In the interest of technological progress, all products are subject to design and/or material change without notice.

