

HC Valve - 10" through 20" diameter

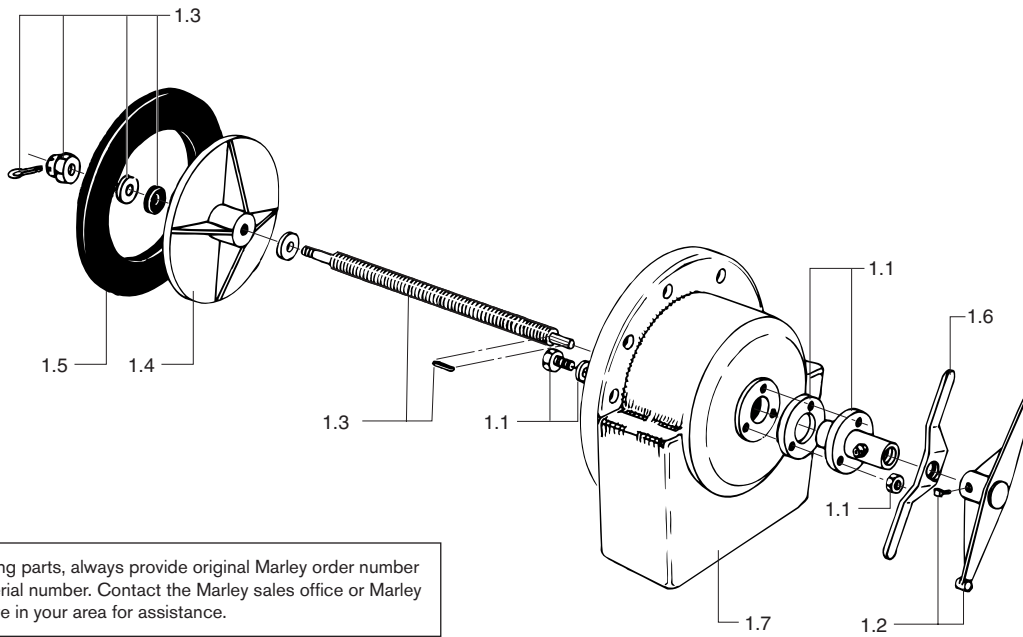

When ordering parts, always provide original Marley order number and tower serial number. Contact the Marley sales office or Marley representative in your area for assistance.

Replacement Parts

- 1.0 Complete Horizontal Control Valve Assembly
- 1.1 Valve stem guide with grease fitting, gasket, and attaching hardware
- 1.2 Operating handle with set screw
- 1.3 Valve stem with key, washers, resilient washer, castle nut and cotterpin
- 1.4 Valve disc
- 1.5 Valve body gasket
- 1.6 Locking bar
- 1.7 Valve body

Assembly Sequence

- 1—Attach valve stem guide and gasket to valve body.
- 2—Place valve disc and washers on valve stem. Install castle nut and tighten to compress resilient washer to $\frac{1}{8}$ " to $\frac{3}{16}$ " thick. Install cotter pin.
- 3—Install valve stem and disc subassembly through valve stem guide. Center valve disc in valve inlet opening by differential tightening of the three valve stem guide machine bolts.
- 4—Install locking bar on valve stem.
- 5—Insert key in valve stem keyway and install operating handle. Tighten set screw against key.
- 6—Grease valve stem threads at grease fitting using rust inhibiting lithium base grease of NLGI No. 2 consistency. Coat exposed valve stem threads with grease.
- 7—After adjusting the flow, set the locking bar in the locked position to stabilize the stem and disc.

SPX COOLING TECHNOLOGIES, INC.

7401 WEST 129 STREET
 OVERLAND PARK, KS 66213 USA
 913 664 7400 | spxcooling@spx.com
 spxcooling.com

Z0238929_A (92-1370) | ISSUED 06/2017
 COPYRIGHT © 2017 SPX CORPORATION

In the interest of technological progress, all products are subject to design and/or material change without notice.

