

HC valve 4" - 6" - 8" diameter

ASSEMBLY - PARTS LIST

Z0238930_A ISSUED 02/2017

READ AND UNDERSTAND THIS MANUAL PRIOR TO OPERATING OR SERVICING THIS PRODUCT



assembly - parts list

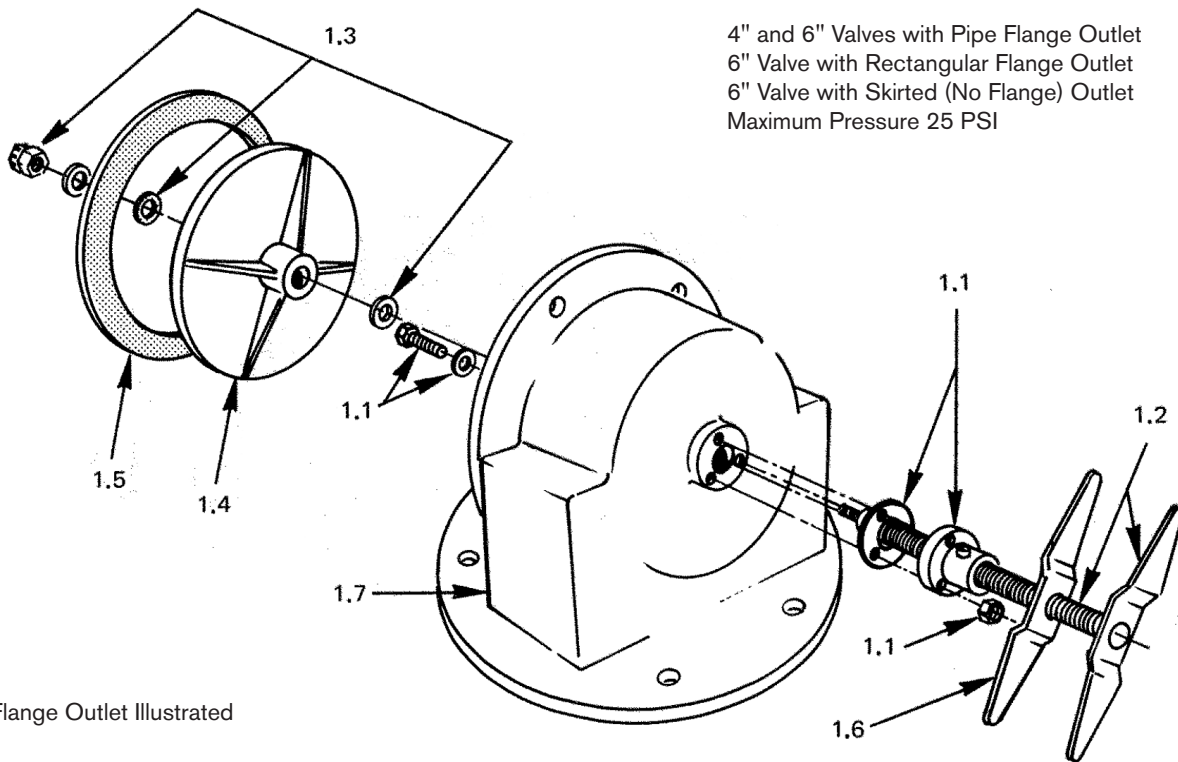

4" and 6" Valves with Pipe Flange Outlet
 6" Valve with Rectangular Flange Outlet
 6" Valve with Skirted (No Flange) Outlet
 Maximum Pressure 25 PSI

Pipe Flange Outlet Illustrated

Assembly Sequence

1. Attach valve stem guide and gasket to valve body.
2. Install locking bar on operating handle and valve stem sub-assembly.
3. Install operating handle and valve stem sub-assembly with locking bar through valve stem guide.
4. Place valve disc and washers on valve stem. Install self-locking nut and tighten to compress resilient washer to $\frac{1}{8}$ " to $\frac{3}{16}$ " thick. Center valve disc in valve inlet opening by differential tightening of the three valve stem guide machine bolts.
5. Grease valve stem threads at grease fitting using rust inhibiting lithium base grease of HLG1 No 2 consistence. Coat exposed valve stem threads with grease.
6. After adjusting the flow set the locking bar in the locked position to stabilize the stem and disc.

Replacement Parts

- 1.0 Complete Valve Assembly
Ready for installation.
- 1.1 Valve Stem Guide With Grease Fitting, Gasket and Attaching Hardware
- 1.2 Operating Handle And Valve Stem Sub-Assembly
- 1.3 Washers, Resilient Washer, Self-Locking Nut
- 1.4 Valve Disc
- 1.5 Valve Body Gasket
- 1.6 Locking Bar
- 1.7 Valve Body

When ordering parts always provide original Marley tower order number and tower serial number. Contact the Marley sales representative in your area for assistance.

assembly - parts list

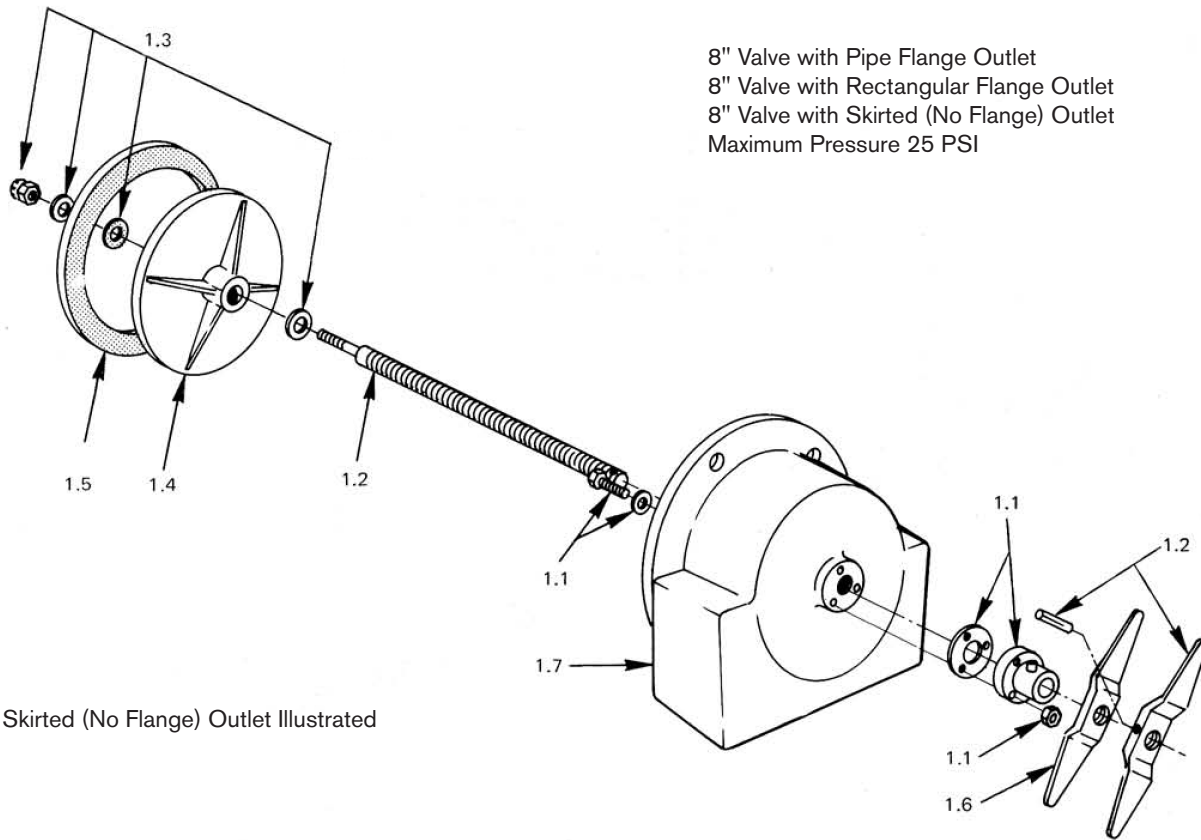

Skirted (No Flange) Outlet Illustrated

Assembly Sequence

1. Attach valve stem guide and gasket to valve body.
2. Place valve disc and washers on valve stem. Install self-locking nut and tighten to compress resilient washer to $\frac{1}{8}$ " to $\frac{3}{16}$ " thick.
3. Install valve stem and disc sub-assembly through valve stem guide. Center valve disc in valve inlet opening by differential tightening of the three valve stem guide machine bolts.
4. Install locking bar on valve stem.
5. Install operating handle on valve stem and insert pin through valve stem and operating handle.
6. Grease valve stem threads at grease fitting using rust inhibiting lithium base grease of NLGI No. 2 consistence. Coat exposed valve stem threads with grease.
7. After adjusting the flow, set the locking bar in the locked position to stabilize the stem and disc.

Replacement Parts

- 1.0 Complete Valve Assembly
Ready for installation.
- 1.1 Valve Stem Guide With Grease Fitting, Gasket and Attaching Hardware
- 1.2 Operating Handle, Valve Stem, Pin
- 1.3 Washers, Resilient Washer, Self-Locking Nut
- 1.4 Valve Disc
- 1.5 Valve Body Gasket
- 1.6 Locking Bar
- 1.7 Valve Body

When ordering parts always provide original Marley tower order number and tower serial number. Contact the Marley sales representative in your area for assistance.

SPX COOLING TECHNOLOGIES, INC.

7401 WEST 129 STREET
OVERLAND PARK, KS 66213 USA
913 664 7400 | spxcooling@spx.com
spxcooling.com

Z0238930_A (M92-1371) | ISSUED 02/2017

COPYRIGHT © 2017 SPX CORPORATION

In the interest of technological progress, all products are subject to design and/or material change without notice.

